

Sketch 1 – View of Proposed Project from Above

The shaded area will contain amended soils and vegetation in a raised terrace. Street runoff will flow through openings in the curb, enter the rain garden, and soak into the ground. The soils and plants in the rain garden will act as a filter to help remove pollutants from the stormwater.

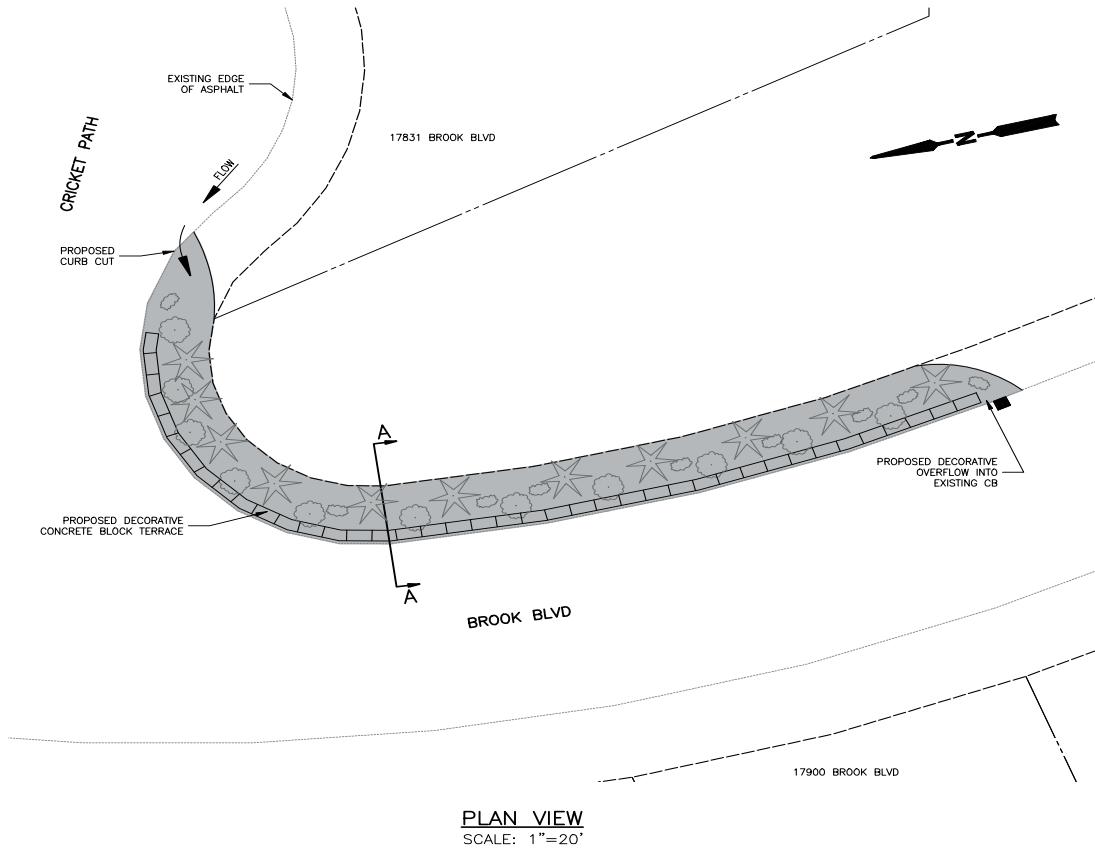

Sketch 2 - View of Proposed Project from the Side

Existing soils will be amended, and a raised terrace will be created to contain additional soil that will encourage healthy plant growth and absorb stormwater. This will better mimic conditions before development, when a lot more rainwater was able to soak into the ground.

